

Milton Studio News

Issue 22

Winter 2012/13



Celebrating 35 years with new Aberdeen base



Coinciding with our **35th Anniversary** we are delighted to announce the opening of a new office at **52 Bon Accord Street in Aberdeen** from 1 February 2013.

Since Christmas Eve 1977 when Fred and Rosemary started the business from a room in their house the practice has developed, moving in 1982 into the first **Milton Studio** designed by Fred, then becoming a Partnership in 1989. Steady growth resulted in the **Stirling** office opening in 1996 and in 2006 our head office moved from Glenogilvy to the current new studio in **Glamis** village. Ian Cruickshank of Armours QS, our **Aberdeen** landlord pictured with Fred and Rosemary. Fred's vision for our Aberdeen expansion is a positive move which has us all very excited!

Editor's Comment

Welcome to our 22nd issue of James F Stephen Architects' newsletter.

On Christmas Eve we celebrated the founding of the Practice **35 years** ago when Fred left the relative security of employment to "go it alone". Supported by Rosemary, with their two young sons and two dogs, they ventured into the world of business where "watering down the mince" was occasionally necessary!!

"Never forget your roots" is the mantra repeated by Fred and maintaining this philosophy has continued to bring us projects, large and small, as we moved through the last few years of global economic downturn.

We continue to serve regular and new clients whether the project is small or large, new-build or restoration. This is an appropriate time to thank clients for their faith, trust, loyalty and repeat business.

It is most satisfying that the Dundee Institute of Architects has selected our clients to receive their "Client of the Year" annual award on three occasions, recognising their vision and contribution to the architectural landscape of Scotland. Over 35 years many lessons have been learned and progress made. From pen, ink and scale rule on the drawing board to the sophisticated Building Information Modelling (BIM) technology in use today, we remain at the forefront of our profession. Our expansion from Glamis and Stirling to Aberdeen is an exciting start to 2013.

More Award Successes

We were delighted to receive a total of 4 Awards at the recent DIA Awards Dinner. Our redevelopment of **Aystree House** in Broughty Ferry received the Award for Best Regeneration/Conservation Project, **Aystree Stables** won Best Interior Design Award and our client for these projects, Morton Properties (Dundee) Ltd secured the Best Commercial/Private Client Award, the third time one of our clients has won this award since it's inception in 2006. In addition to this, our redevelopment of the **Merchant's House** in Brechin received a Commendation in the Best Regeneration/Conservation category.



- Aystree House -



- Presentation of Awards -

Foreign Affairs

The next phase of restoration and adaption at Albergo Casanova in **Tuscany** is under consideration for progression towards the construction stage. In Phase 1 the main Villa was adapted into a quality boutique hotel now awarded 5 star status.



- Merchant's House -

SUCCESS in 2013

The Partners and Associates wish all staff, clients, fellow consultants and friends Best Wishes for a successful and fulfilling year ahead in 2013



Fred, Rosemary, Doug, Paul & David

Planning Permissions

At Planning Stage is the Holiday Home Provision for people affected by MS at Lundin Links, Fife for Homelands Trust.



- Lundin Links -

Planning Permission has also been granted for alterations to The Lodge, Aystree, **Broughty Ferry** and 170 Dickson Avenue, **Dundee** for Caledonia Housing Association; an extension to an existing residential property in Maryton, **Kirriemuir** which Angus Council initially intended to refuse on policy grounds, however JFSA's specific planning experience and 3D graphic imaging skills resulted in full approval being granted with works now due to start on site in late Spring 2013.

Building Warrant

Building Warrant Approval has been received for the proposed conversion and alterations at **Taybank, Hill Street, Monifieth**.

The project to restore and adapt the Category B Listed **Cambo Farmhouse** and Steading to residential use for Cambo Estate has been submitted for Building Warrant Approval and is anticipated to start on site during the early summer months of 2013.

Another project in **Fife** to develop 22 new houses within the village of **Kingsbarns**, including 10 houses grant aided by the Scottish Government's Pilot Scheme for "Rural Homes for Rent" has been developed to Building Warrant stage and is anticipated to start on site in late Spring of 2013. This project is being developed for Cambo Estate in partnership with Ogilvie Homes with the Phase 2 development of a further 18 private houses currently being advanced towards a site start later in the year.

Snippets of Interest

We were recently listed in Urban Real magazine as one of the "Top 100 Architects" and as one of the 'practices to watch in 2013'.



- 52 Bon Accord Street, Aberdeen -

Sketchup Images



Sheill Street, Broughty Ferry

Conservation News

JFSA are assisting the Dean & **Peterborough Cathedral** along with Kit Martin (Historic Houses Rescue) Ltd to explore the potential opportunity to repair, restore and adapt the 18th Century Grade 1 Listed **Laurel Court House** in a manner that will assist in securing a sustainable future for the property which is located within the heart of the Cathedral Precinct.

The project to repair and adapt the Category A Listed **High Mill** at Verdant Works, **Dundee** continues to progress with Dundee Heritage Trust having submitted a Stage 1 Application for HLF grant assistance. Historic Scotland have agreed to support this nationally important project in the form of a Buildings Repair Grant.



- Laurel Court House -



- Gardner Memorial Church -

The Feasibility Studies to assist in exploring enhanced use for the Category A Listed **Gardner Memorial Church** in **Brechin** and the Category B Listed **Lethnot Parish Church** in **Edzell** are well underway and due for completion in Spring 2013. Both projects are likely to incorporate alterations and extensions that will result in more appropriate and relevant use of internal spaces within the buildings. The Feasibility Study to explore adaptive and enhanced use for the former Category B Listed **Blaigowrie Hill Kirk** is complete and the **Blaigowrie Players** are in the process of applying for grant funding assistance to move the project forward. Listed Building Consent has been received for the conservatory replacement in **Broughty Ferry**.



- Aitken Den, Letham Grange -



- High Mill, Verdant Works -



- Westerlea Drive, Bridge of Allan -

Designs in Progress



- Isle of May Visitor Centre -

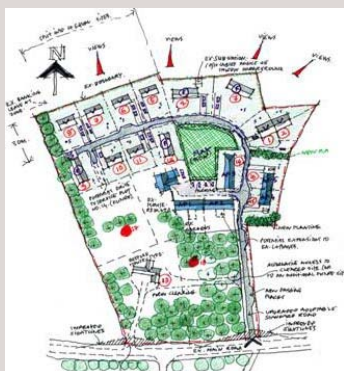

- St Andrews Housing Layout -



- Smiddy, Glamis -

Design proposals have been finalised for the **Isle of May Visitors Facility** and a detailed planning application has been submitted to **Fife Council**. The site lies within a **National Nature Reserve** and **Site of Special Scientific Interest**. Drawing work is progressing for: a house and garage extension at **Letham Grange, Arbroath**; and we continue to liaise with our clients in **Australia** about their plans for the restoration of the **Category C Listed Smiddy in Glamis**. Initial sketches have been created for 15 proposed holiday houses and 2 new individual houses in **St Andrews** and we continue to work on the proposed modernisation of the **Grade B Listed St Cyrus Church**. We are also coordinating work on a new sprinkler system at **David Irons, Forfar** for **Lord Strathmore**. Detailed design work has commenced to develop 18 large private family houses within the village of **Kingsbarns, Fife** for **Cambo Estate** in partnership with **Ogilvie Homes** and work has commenced on the **Feasibility Study** for a new **Visitor Centre in Braemar** for **Braemar Royal Society Highland Games**.



Invited to Speak

Partner, **Paul Stephen** gave a presentation on our practice's work to **Dundee Civic Trust**. The talk gave a "potted history" of our practice from **Fred's first project** through to our more recent projects some which are currently "on the drawing board"! The **Trust** commented that "it was evident from the response of the people present that we all found your talk very interesting and were impressed with the variety of work your practice is involved in".

Paul was also invited to give a presentation to the **Scottish Churches Heritage Research Annual Conference** at the **Scottish Storytelling Centre** in **Edinburgh** on our various Church projects over the years. Feedback on the presentation commented on the "splendid" and "stimulating" talk and that members of the audience were "amazed" and "impressed" at the number of Church projects completed by **JFSA**.

Recently Completed

Housing developments at **Marchburn Drive** and **Oldcroft, Aberdeen** for **Robertson Construction Eastern Ltd** and **Erskine/Dura Street, Dundee** for **Home Scotland** have all recently been completed.



- Oldcroft, Aberdeen -

Projects 'On Site'

Following the sad news of the demise of **WH Brown Construction**, work has restarted on site for the **Very Sheltered Housing** at **Elmgrove, Dundee** with contractors **George Martin Builders** as well as the housing at **Maxton Road, Crieff** with contractors **Muirfield Contracts** both for **Hillcrest Housing Association**. Roofing works are also now complete at the **Maggie's Centre, Dundee**.



- Elmgrove, Dundee -

The **Category B Listed Gateway at Scone Palace** has been successfully reinstated. Works involved contributions by specialist engineers and stone conservators/sculptors co-ordinated by **JFSA**.

The new family room extension to replace a storm damaged conservatory at a private house at **Kilmacolm** makes the most of the magnificent, south facing view.



- Maggie's Centre, Dundee -



- Maxton Road, Crieff -



- Private House, Kilmacolm -

Staff Matters



Congratulations to **Allan & Lynsey Reid** who were married on Friday 27 July in Las Vegas – family & friends watched the event on the internet.

We are currently participating in the Toolbox training scheme run by Hillcrest Housing Association and welcome **Callum Etechs** who has joined us as a trainee under their "Get Ready for Work" programme. He has settled in well and we hope that after his initial three months work experience Callum will remain with us as an apprentice technician. As we go to press the BBC are planning a documentary featuring Callum's role in our practice. Watch this space.....

Well done to **Graham Mitchell** and **Les Smith** for their efforts in raising £300 for Prostate Cancer charity. We also raised



£50 this year towards **Wear it Pink Day** in support of Breast Cancer Care. In addition we support local children's groups and the **Dundee Maggie's Centre**.



Congratulations also to our Interior Designer/Researcher, **Lynne Wheeler** & her partner, **Markos** on the birth of their daughter, **Kassi**, born 29 August 2012

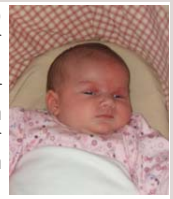

Steven Anderson, Associate and Senior Technologist in our Stirling office, celebrates **25 years** with JFSA since he joined us on leaving school.



Andrew Smith a Senior Technician and JFSA Associate, OHSAS Co-ordinator and BIM Mentor, recently celebrated **15 years** with the practice.



Our Annual Christmas 'get together' was held again in the **Hotel Broughty Ferry** where staff from Glamis and Stirling enjoyed lunch and some stalwarts socialised in "the Ferry" later.

Continuing Professional Development

Doug Reid attended an Institute of Historic Building Conservation Training Day in Maryhill Burgh Halls in Glasgow in November 2012. This focussed on Community Asset Transfer and the work of the Community Ownership Support Service Development Trust Association Scotland in relation to the potential acquisition of Historic Buildings, in public ownership, listed on the Buildings at Risk Register for Scotland.

David Stephen attended a renewable conference in Dundee to maintain our current knowledge base in this field and we held another "in house" training day where members of staff shared their growing proficiency in Revit to expand the use of our BIM software throughout the practice.

Mike O'Donnell continues to arrange our CPD Programme and the forthcoming events include: Illuminated U-Profile Glazing Systems; Heating Homes with Air & Ground Source Heat Pumps; Heating your Building, Designing & Enabling the Roof to Work Harder; Ceiling Design Solutions; Living Walls & Green Roofs; Light from Above; Integration of Security Equipment into Building Design; EWGECO monitoring equipment; Professional Indemnity Insurance; Claims; and Collateral Warranties. We extend an invitation to other consultant design team members to join in by arrangement.

ICT Update

We have successfully upgraded our Stirling Office to Revit 2013 keeping us up to date with the latest product releases. Provisions are in place to accommodate the ICT requirements of a new tenant renting part of our Glamis office space and as we go to print, we are already setting up a video conferencing facility with our Aberdeen office.

Social Networking



[facebook.com/jfsarchitects](https://www.facebook.com/jfsarchitects)



twitter.com/jfsarchitects

We now have over 160 Facebook "likes"

Head Office:

Milton Studio, Glamis, Angus DD8 1RG
t: 01307 475000

Also at:

Milton Studio, 5 Viewfield Place, Stirling FK8 1NQ
t: 01786 446939

52 Bon Accord Street, Aberdeen AB11 6EL
t: 01224 471414

Partners:

Prof James F Stephen

Rosemary C Stephen

Douglas J Reid

Paul Stephen

David Stephen

Associates:

Frank A Robb

Steven Anderson

Michael E O'Donnell

Andrew A Smith

Consultant:

Roy Clark